

# Fred.

ESTATE AGENTS



## 16 Whittagreen Court

Motherwell

**Offers over £85,000**













Situated within this well maintained development within the town of Motherwell, lies this well appointed first floor two bedroom apartment.

Upon entering the property, you are welcomed into a bright entrance hallway with laminate flooring, leading through to a spacious lounge. The lounge is enhanced by a large front facing double glazed window, allowing an abundance of natural light to fill the room. The fitted kitchen offers a range of wall and floor mounted units and is equipped with a built-in oven and gas hob, with additional space for freestanding appliances.

There are two well proportioned double bedrooms, both carpeted and finished in neutral décor, providing ample space for bedroom furniture. Completing the accommodation is a partially tiled bathroom comprising a WC, wash hand basin, and a bath with an overhead shower.

Further benefits of this attractive apartment include secure door entry, gas central heating, and residents’ parking.

Motherwell offers a great selection of shops, bars, restaurants and leisure facilities. It is perfectly located for the commuter, with the M74 and M8 providing convenient access to the central belt. The town also offers excellent public transport, with train and bus services providing links to the surrounding areas.

Viewing

Please contact us on 01698 305618 if you wish to arrange a viewing appointment for this property or require further information.

These particulars, whilst believed to be accurate are set out as a general outline only for guidance and do not constitute any part of an offer or contract. Intending purchasers should not rely on them as statements of representation of fact, but must satisfy themselves by inspection or otherwise as to their accuracy. No person in this firms employment has the authority to make or give any representation or warranty in respect of the property.

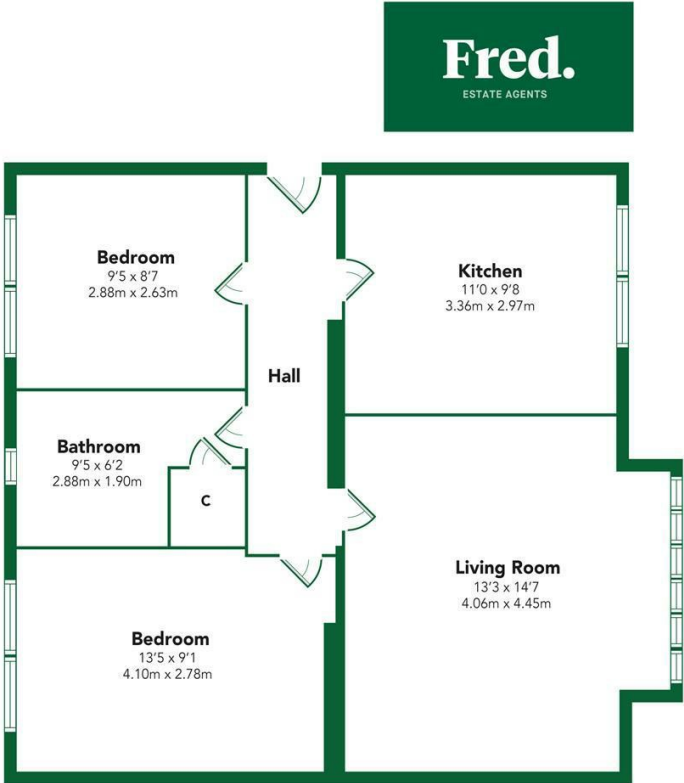

Floorplans are indicative only - not to scale  
Produced by Plush Plans Ltd

Energy Efficiency Graph

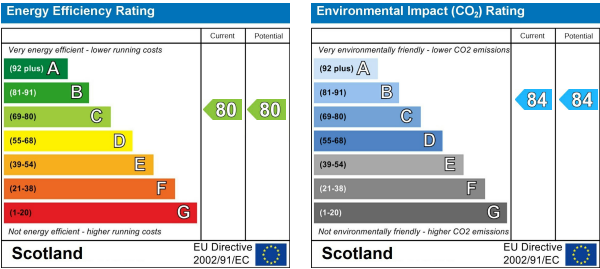

438 Brandon Street, Motherwell, North Lanarkshire, ML1 1XA  
01698 305618 | info@fredestateagents.co.uk